

Brugermanual



WI-FI

Toshiba Home AC Control



Indhold

- 4 Søg efter 'Toshiba Home AC Control' og hent appen
- 5 Om 'Toshiba Home AC Control'
- 5 Registrering
- 6 Log ind på 'Toshiba Home AC Control'
- 7 Tilslutning til 'Toshiba Home AC Control'
- 9 Driftstilstand og indstillinger
- 10 Indstillinger i driftstilstand
- 11 Indstillinger i ugeprogram



Toshiba Home AC Control

Livsstil

HENT



Søg efter 'Toshiba Home AC Control' og hent appen.

Om 'Toshiba Home AC Control'

1. 'Toshiba Home AC Control' kan kontrollere enheder fra en smartphone eller tablet via din internetforbindelse.
2. Der kan registreres maks. én e-mailadresse pr. WiFi modul.
3. Der kan registreres op til fem brugere pr. WiFi modul.

Registrering

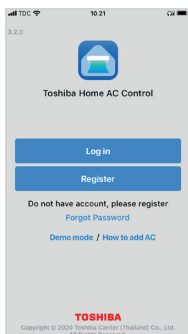

- 1 Klik på 'Register'.

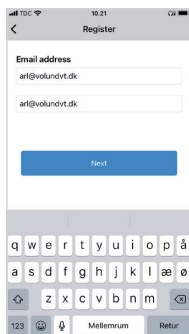

- 2 Indtast email-adresse.

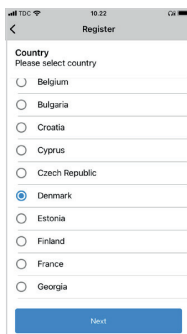

- 3 Vælg land.

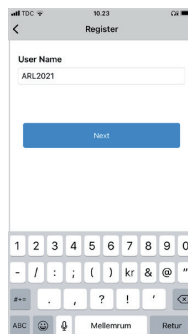

- 4 Indtast et ønsket brugernavn.

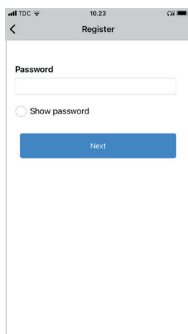

- 5 Indtast adgangskode, 6-10 bogstaver og tal.

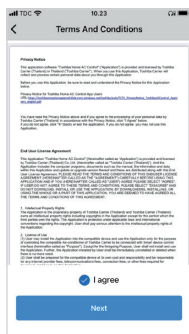

- 6 Acceptér betingelserne.

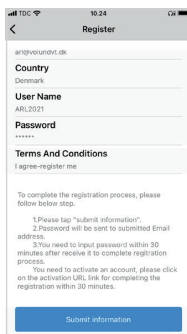

- 7 Bekræft oplysningerne.



- 8 Du modtager en mail. Klik på linket i mailen for at bekræfte din oprettelse, før du kan gå videre.

Log ind på 'Toshiba Home AC Control'



VIGTIGT!

1. Hvis du ændrer indstillinger på din router eller skifter e-mailadresse skal du gentage tilslutningen af WiFi modulet efter ændringerne.
2. Hvis du ønsker at benytte WiFi modulet til en anden enhed, skal modulet først nulstilles til fabriksindstillinger og herefter gentages tilslutningen af WiFi modulet.

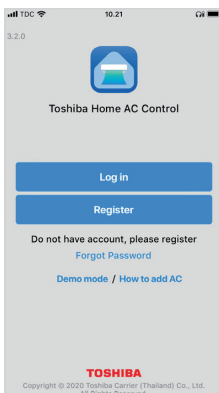

1 Åbn appen.

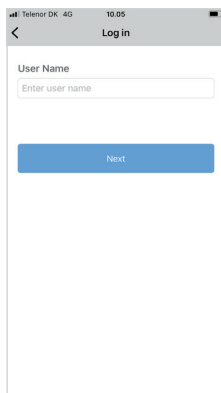

2 Indtast brugernavn.

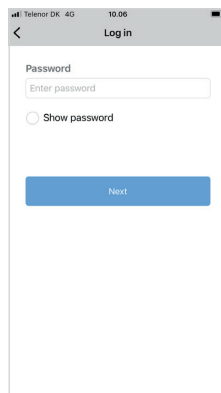

3 Indtast password.

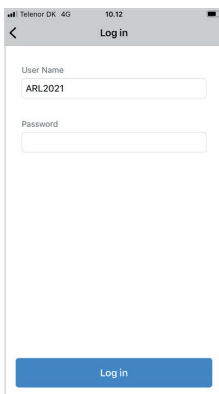

4 Log in.

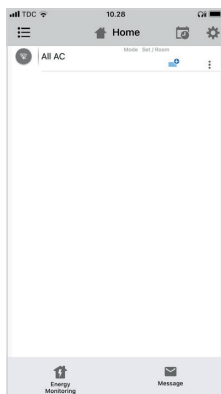

5 Login gennemført.

Tilslutning til 'Toshiba Home AC Control'

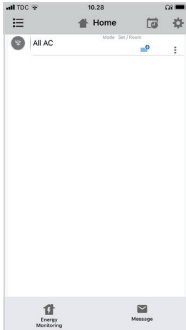

1 Tryk på 'tandhjulet' på startside.

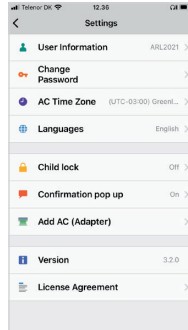

2 Vælg 'Add AC (Adapter) (Adapter)'.



3 Vælg 'Wireless Adapter Built-in'.

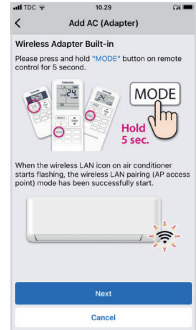

4 Hold 'setup' knappen på 'WiFi modulet' inde i ca. 5 sekunder.

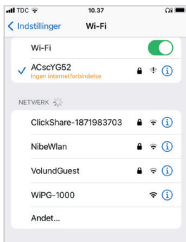

5 Skift fra appen til 'settings' på telefon/tablet og gå ind i Wi-Fi indstillinger og vælg din enhed. Se label på 'WiFi modulet'.



6 Indtast password fra WiFi modulet.

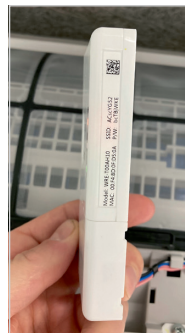

7 SSID og password findes på siden af 'WiFi modulet'.



8 Vælg 'Forbind'.

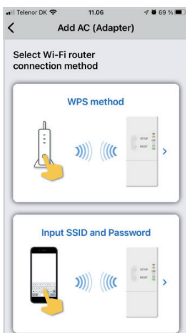

9 Skift tilbage til appen og vælg 'Input SSID and password'.

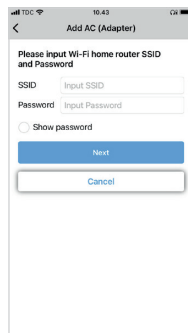

10 Indtast SSID og password til WiFi netværket (står typisk i bunden af routeren).

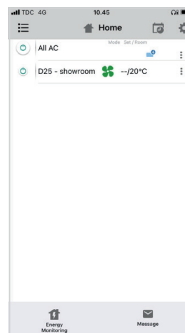

11 Tilslutningen er nu færdig.

Tilslutning til 'Toshiba Home AC Control'

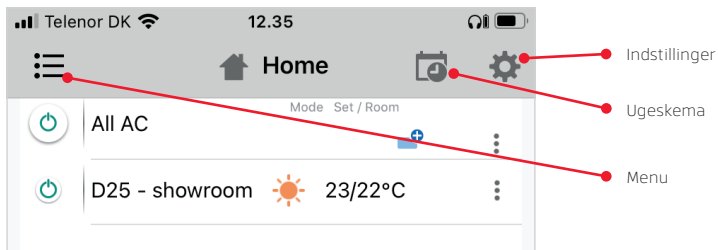

1 Startskærm.

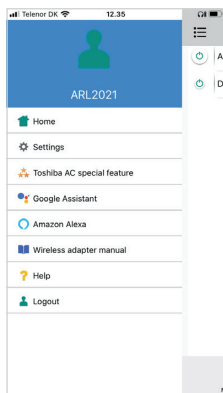

2 Menu.

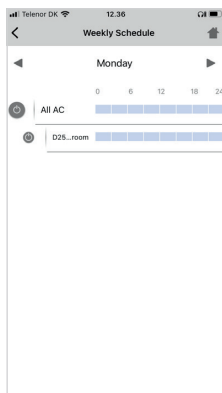

3 Ugeskema.

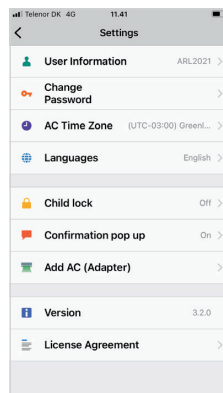

4 Indstillinger.

Driftstilstand og indstillinger

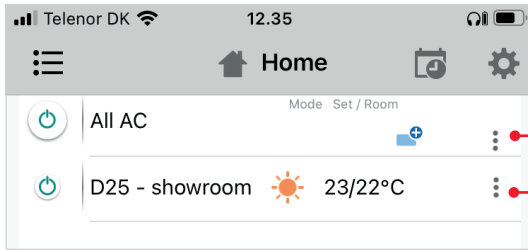

Driftsindstillinger ved flere enheder

Driftsindstillinger for den enkelte enhed

Mulighed for 5 driftstilstande/modes

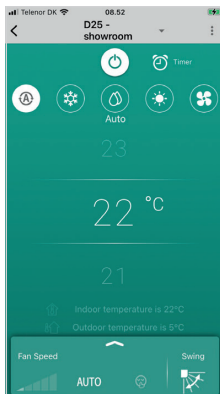

Auto

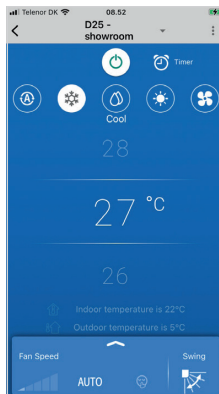

Køling

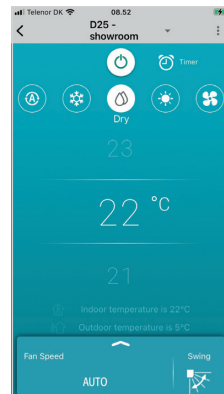

Affugtning

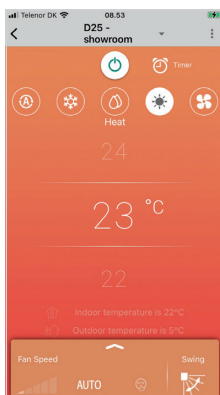

Varme

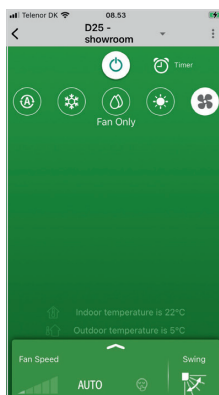

Ventilation

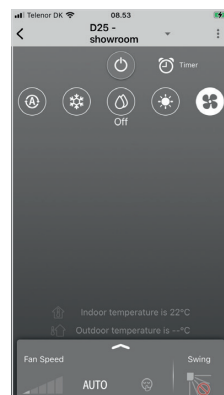

Slukket

Indstillinger i driftstilstand

Ugeprogram

Klik for at vælge enhed

On-Off-timer

Temperatur

Indendørs temperatur

Udendørs temperatur

Indblæsningshastighed og louver-retning

Specielle funktioner

Off Timer
Please select hour
Clear Timer
0.5
1
1.5
2
2.5
CANCEL START

On Timer
Please select hour
Clear Timer
2.5
3
3.5
4
4.5
CANCEL START

Indstillinger i ugeprogram

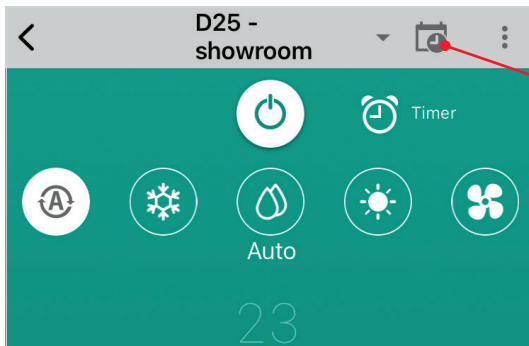

Vælg ugeprogram

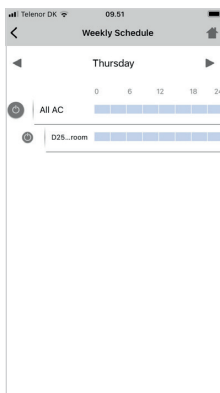

1 Vælg enhed.

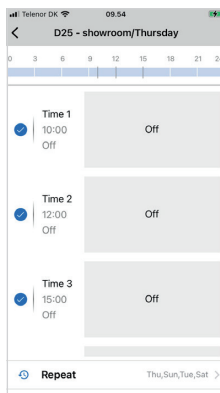

2 Vælg intervaller.

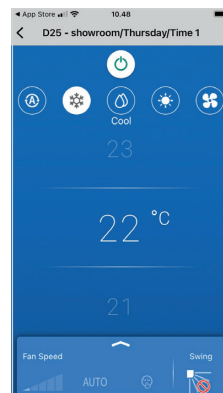

3 Vælg driftstilstand for intervallet.

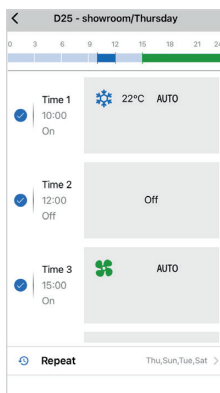

4 Oversigt over driftsindstilling for intervallerne.

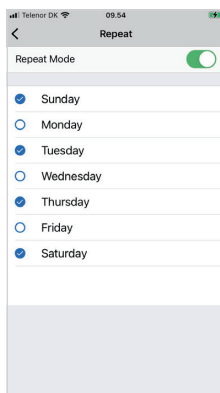

5 Mulighed for at vælge gentagelse af intervaller.



VØLUND VARMETEKNIK

Erhverv 97 17 20 33
Privat 97 17 20 52

volundvt.dk